

## 1 What's in the box

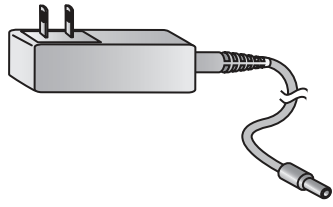

TransPort WR21



Power Supply  
(some models may have a DC power cord or have no power supply)



Power Supply Adapters  
(non-US models only)

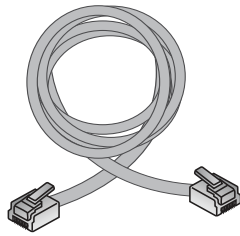

Ethernet Cable

### Required additional equipment

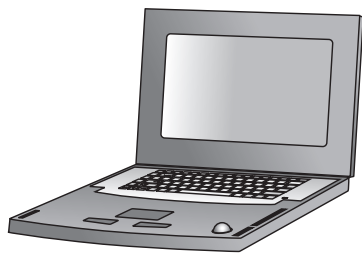

A personal computer



## Quick Start Guide

### TransPort WR21



90001452-88 A

If any item is missing or damaged, please contact your supplier. Note any damage that may have occurred during shipping and report it to the supplier. Depending on model and configuration, the box contains additional cables/antennas as appropriate.

## 2 Connect the hardware

**a** Connect one end of the Ethernet cable to the **LAN 0** port on the unit and the other end to a LAN port on a PC.

**b** Connect the power supply. Depending on model, the unit will either come with an AC power supply or DC power cord with one of the following plug types.

**Barrel Plug-Type Variants:** Connect the barrel plug end of the power supply to the power connector on the unit, and plug the other end into a wall outlet.

- International units come with interchangeable power supply adapters which can be used according to regional needs.

- The barrel plug end of the power supply has a twist-lock connector which can be secured by rotating it 90 degrees once installed into the Digi TransPort unit.

**Terminal Block Variants:** Remove the pluggable connector from the unit and screw-down a proper power source to its terminals. Once complete, reconnect the pluggable connector to the unit, following the pin-out diagram below.

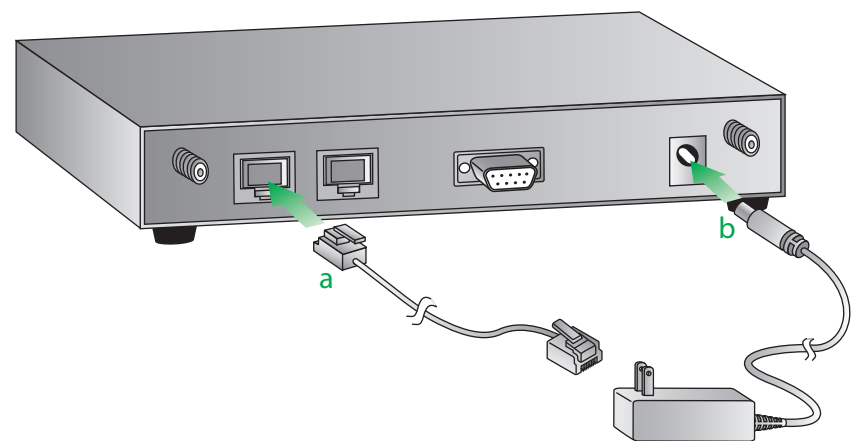
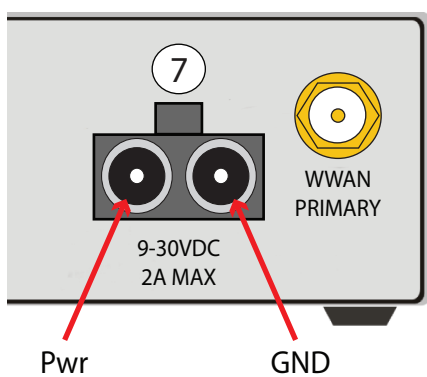

**c** When the unit is powered-up, the **POWER** indicator will illuminate and the unit will initiate a series of diagnostic self-tests. During this process one or more of the other indicators will flash to show that the unit is busy. When the flashing stops, the unit has completed its self-test diagnostics and is ready to be configured.

**Mounting Tips:** Position the Digi TransPort WR21 on a flat, level surface or via wall-mount, rackmount, or DIN rail mounting brackets in a location with adequate ventilation. The unit is designed for indoor use. Do not expose the unit to extremes of heat or cold, strong magnetic fields, or liquids.

### 3 Run the Getting Started Wizard

- a If your PC is configured to automatically get an IP address, it can get an IP address from the TransPort WR21. Otherwise, make sure your PC can connect to the network **192.168.1.0 (255.255.255.0)**.
- b Enter **192.168.1.1** into the address bar of the web browser.
- c The first page of the Getting Started Wizard is displayed. This wizard guides you through initial configuration for your TransPort device.  
**Note:** The default username and password to log in to the TransPort device are **username** and **password**.  
- To run the wizard, click **Get Started**.  
- To manually configure the TransPort device, click **Skip Wizard**.

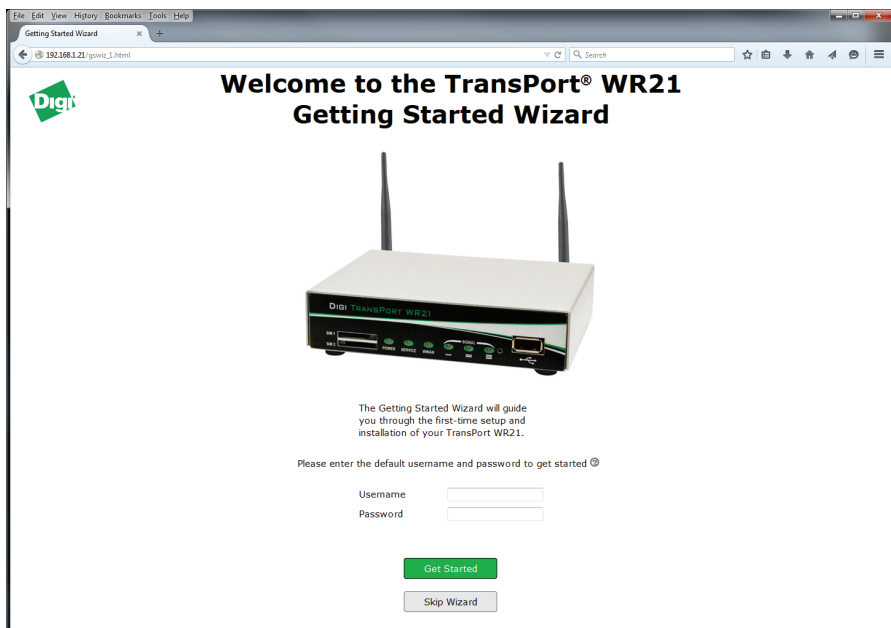

### 4 View the TransPort LEDs and startup states



- **POWER LED:**  
Off: No power.  
Green: TransPort device is powered.
- **SERVICE LED:** Not operational.
- **WWAN LED:** Not operational.
- **SIGNAL LEDs:** Not operational.

### 5 Next Steps

After the Getting Started Wizard completes, the TransPort web interface is displayed. For additional configuration, use the web interface and refer to the *Digi TransPort Users Guide* and *Application Notes* provided on the TransPort Documentation page on the Digi website ([www.digi.com/support](http://www.digi.com/support)).